

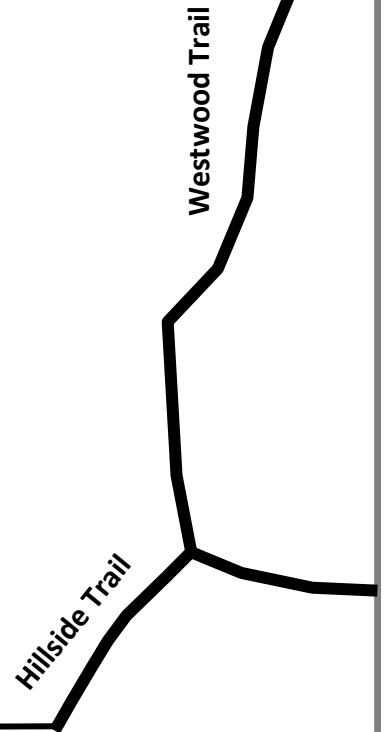

# Westwood Park 64 Acres

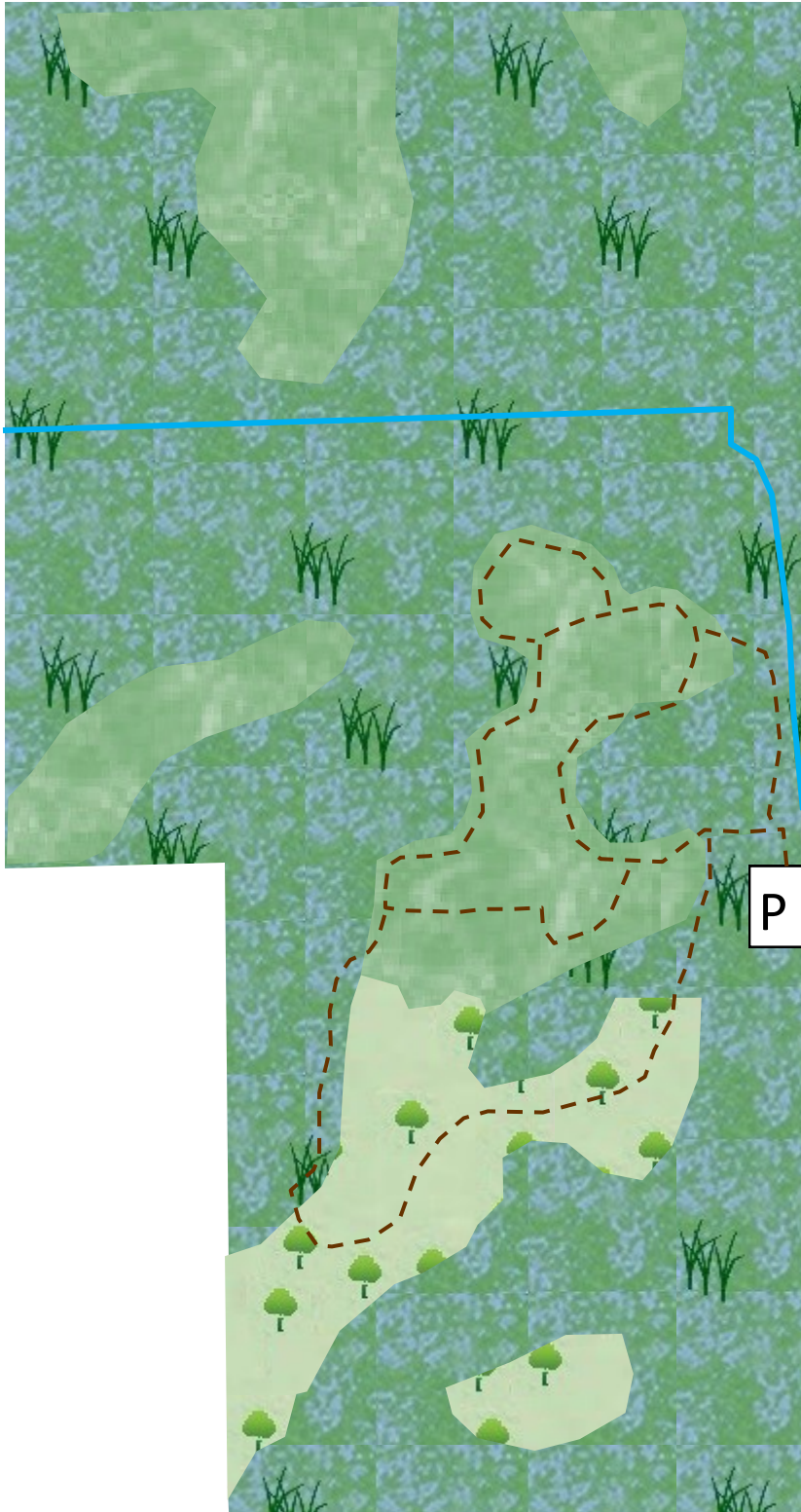

## Key

P Parking

 Woodland

 Wetland

 Prairie

 Trail



## SITE LOCATION

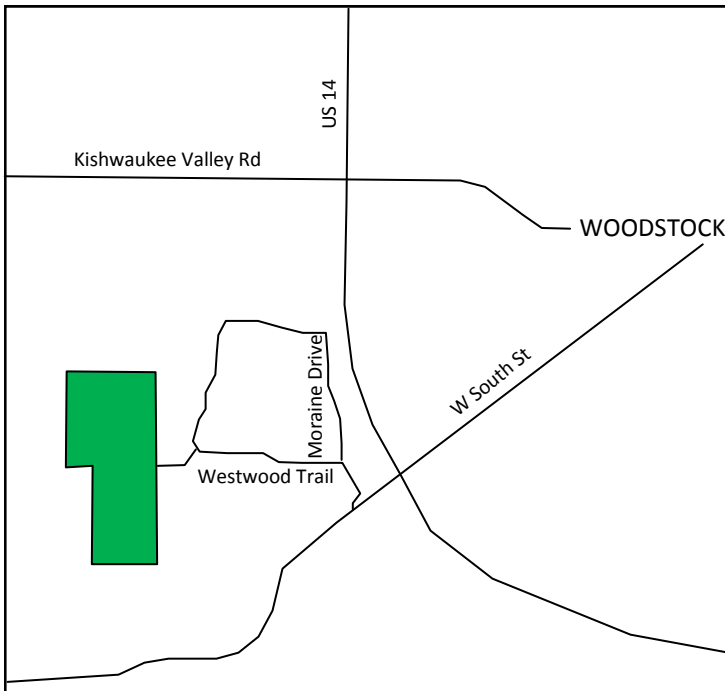

## GENERAL RULES

- Site hours are sunrise to sunset.
- No alcohol.
- Pets must be leashed at all times.
- No camping.
- No fires.
- No removal or disturbance of any plant or animal life.

## INFO AND HISTORY ABOUT SITE

This city of Woodstock Park is managed for conservation through the Land Conservancy. This park is part of a much larger natural wetland complex covering approximately 260 acres and consisting of a mosaic of prairies, wetlands, and oak savannas. Westwood Park has a rich diversity of plant species and habitats that support local populations of wildlife, including several state-threatened species. The oak woodland has a beautiful carpet of native grasses and wildflowers underneath. Trails wind through the prairie and woodland areas, but most of the land off to the north is too wet to traverse most of the year.



[www.ConserveMC.org](http://www.ConserveMC.org)